

# Joy & Comfort

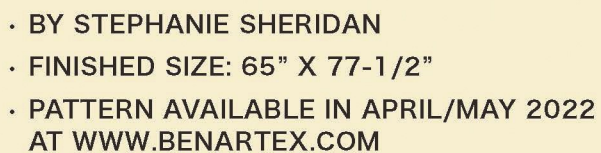



## OF THE SEASON

by Mollie B



## CUTTING INSTRUCTIONS

*WOF = Width of fabric    LOF = Length of fabric    \*Sew strips via short ends, then subcut as indicated in pattern*

	<b>A</b> <b>JOY OF SEASON PANEL</b> 13091-99 <i>Multi</i>	1 Panel	<i>Fussy Cut:</i> (6) 10-1/2" squares		<b>F</b> <b>SEASONAL PLAID</b> 13098-99 <i>Multi</i>	7/8 YD	(2) 3" X WOF strips, subcut (20) 3" squares (8) 2-1/4" x WOF strips *, <b>BINDING</b>
	<b>B</b> <b>JOY OF SEASON STRIPE</b> 13092-07 <i>Cream/Multi</i>	2 YD	<i>Fussy cut from LOF:</i> (4) 8" X LOF strips		<b>G</b> <b>SEASONAL SNOWFLAKES</b> 13099-19 <i>Dk Red</i>	1/4 YD	(2) 3" X WOF strips, subcut (24) 3" squares
	<b>C</b> <b>NATURE SINGS</b> 13094-07 <i>Cream</i>	1/4 YD	(1) 5-1/2" X WOF strip, subcut (3) 5-1/2" squares		<b>H</b> <b>SEASONAL SNOWFLAKES</b> 13099-45 <i>Dk Green</i>	1/4 YD	(2) 3" X WOF strips, subcut (24) 3" squares
	<b>D</b> <b>JOYFUL POINSETTIA</b> 13095-07 <i>Cream</i>	1/4 YD	(1) 5-1/2" X WOF strip, subcut (3) 5-1/2" squares		<b>J</b> <b>JOYFUL INSPIRATIONS</b> 13101-07 <i>Cream</i>	1 YD	(3) 10-1/2" X WOF strips, subcut (31) 3" X 10-1/2" rectangles
	<b>E</b> <b>SEASONAL HOLLY</b> 13096-70 <i>Natural</i>	1-1/8 YD	(6) 5-1/2" X WOF strips *, <b>BORDER</b>		<b>K</b> <b>JOYFUL INSPIRATIONS</b> 13101-70 <i>Natural</i>	5/8 YD	(6) 3" X WOF strips, subcut (24) 3" squares and (24) 3" X 5-1/2" rectangles

### **BLOCK ASSEMBLY:** *Refer to BLOCK DIAGRAMS*

1. Draw diagonal lines on the wrong side of **G** and **H** 3" squares.
2. Place (1) **G** 3" square right sides together on one end of **K** 3" X 5-1/2" rectangle. Sew on drawn line, then trim excess to 1/4" and press open. Repeat on other side to complete **GK UNIT**. Square to 3" X 5-1/2", make (12).
3. Repeat step 2 using **H** 3" squares and **K** 3" X 5-1/2" rectangles to create **HK UNITS**. Square to 3" X 5-1/2", make (12).
4. Sew (1) **GK UNIT** to each side of **C** 5-1/2" square. Sew (1) **K** 3" square to each end of (2) **GK UNITS**, then sew to top and bottom to complete **BLOCK 1**. Square to 10-1/2", make (3).
5. Sew (1) **HK UNIT** to each side of **D** 5-1/2" square. Sew (1) **K** 3" square to each end of (2) **HK UNITS**, then sew to top and bottom to complete **BLOCK 2**. Square to 10-1/2", make (3).

### **BLOCK DIAGRAMS**

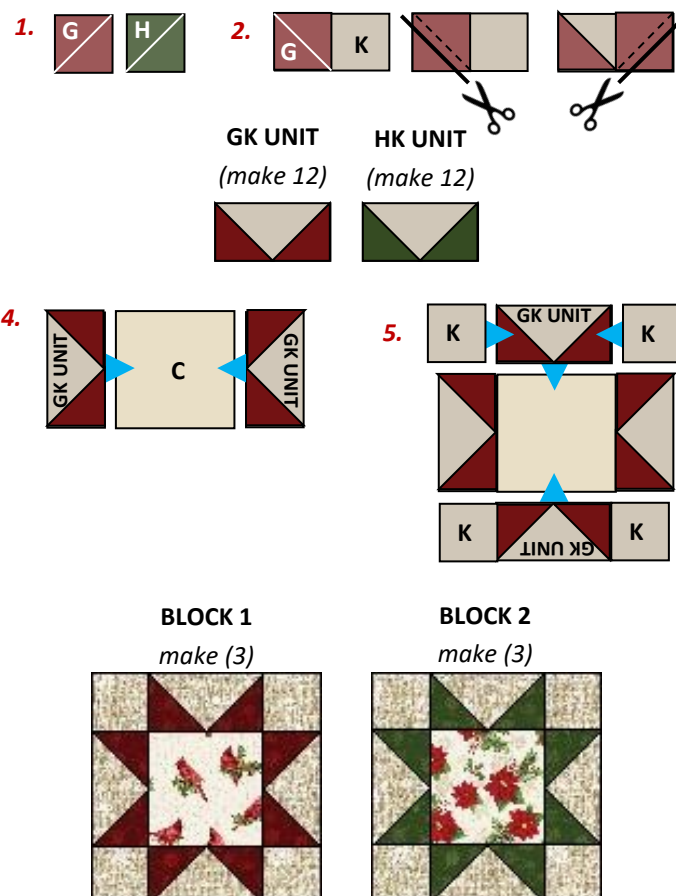

**QUILT ASSEMBLY:** *Refer to **QUILT DIAGRAM** for proper placement and rotation.*

6. Sew (4) **F** 3" squares and (3) **J** 3" X 10-1/2" strips together to create **SASHING ROW**. Make (5).
7. Sew **A** 10-1/2" squares, **BLOCKS** and **J** 3" X 10-1/2" strips together to create rows.  
ROW 1: J Strip - A Square - J Strip - BLOCK 1 - J Strip - A Square - J Strip  
ROW 2: J Strip - BLOCK 2 - J Strip - A Square - J Strip - BLOCK 2 - J Strip  
ROW 3: J Strip - BLOCK 1 - J Strip - A Square - J Strip - BLOCK 1 - J Strip  
ROW 4: J Strip - A Square - J Strip - BLOCK 2 - J Strip - A Square - J Strip
8. Sew **SASHING ROWS** and **ROWS** together.

**BORDER ASSEMBLY:** *Measure width and length of quilt top to ensure border cutting sizes. Below are our measurements.*  
*Refer to **QUILT DIAGRAM** for proper placement and rotation.*

9. Sew (1) **E** 5-1/2" X (53") strip to each side of quilt, then sew (1) **E** 5-1/2" X (50-1/2") strip to top and bottom of quilt.
10. Sew (1) **B** 8" X (63") LOF strip to each side of quilt, then sew (1) **B** 8" X (65-1/2") strip to top and bottom of quilt.

**FINISHING:**

Cut batting and backing 3" larger than top on all sides. Layer backing, batting and top together and baste or pin. When quilting is completed, trim excess batting and backing. Bind with **F** fabric.

*Note: If this Benartex pattern is included in a kit, any questions about the kit should be addressed to the vendor from whom you bought it.*

Share your finished quilt with the Benartex community  
on social media by tagging **#benartex\_fabrics**



Also visit our Sewing Group on Facebook, **Sew Interesting**



JOY & COMFORT  
QUILT DIAGRAM  
SIZE: 65" x 77-1/2"

